

UK's LEADING
WEEDKILLER BRAND†

MAPP No. 20722

ROUNDUP® Weedkiller
Path Optima kills:

REFILL FOR
PUMP 'N' GO PRESSURE SPRAYER

- ✓ CLOVER
- ✓ CHICKWEED
- ✓ COMMON GROUNDSEL
- ✓ MOSS
- ✓ ANNUAL MEADOW-GRASS

INSTRUCTIONS FOR USE

FOR USE ONLY AS AN AMATEUR WEEDKILLER AND MOSSKILLER.

- ✓ Active ingredient naturally breaks down in soil.
- ✓ Use all around permeable paths, patios, driveways and gravel areas.
- ✓ Kills a broad range of annual weeds, grasses and moss.
- ✓ Rainfast 3 hours after application.
- ✓ Fast acting, the first visible effects may be seen within 2-3 hours.
- ✓ Suppresses the top-growth of perennial weeds like dandelion and sowthistle.

WHEN TO USE

- Apply in warm, calm, dry, conditions during April – November when weeds are actively growing.
- Do not apply when there is a risk of frost or drought as weeds will not be actively growing.
- Reapply if it rains within 3 hours of application.
- Reapply 7 to 21 days if required.
- **Maximum 4 applications per year.**



>3 HOURS

HOW TO USE

SHAKE WELL BEFORE USE. Wear gloves and enclosed footwear. This pack treats up to 165 m². Application rate: 300 mL per 10 m².



To refill, remove the pump mechanism by unscrewing in an anti-clockwise direction.



Remove the tamper-evident closure on the refill pack. After use, replace the lid of the refill for the next use.

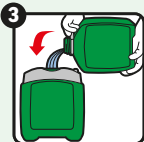

Follow the instructions of the Pump 'N' Go sprayer or those supplied by the manufacturer of your garden sprayer. Pour the required content of the refill pack into your clean, empty Pump 'N' Go sprayer or a dedicated weedkiller sprayer.

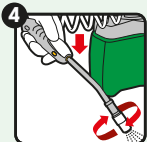

Rotate nozzle to 'spray' or 'stream'. Aim 50 cm from target weed and press white trigger. Spray to lightly wet the leaves avoiding run off. Rotate nozzle to 'stop' after use.

WHERE TO USE



- Use to kill weeds on gravel areas, permeable paths, driveways, patios overlying soil and along fences. Ideal before cropping and ground clearance before cultivation.
- Can be used to clean up weedy or mossy ground before planting veg, flowers, bushes and trees, and to renovate overgrown areas.
- For the control of weed and mosses around ornamental garden plants and trees, on areas not intended to bear vegetation.
- Most effective when applied to newly established weeds or those less than 10-15 cm tall.
- Do not direct spray or allow spray drift onto cultivated plants and lawn as this product destroys all green plant parts.

SAFETY INSTRUCTIONS

Protection during/in use: KEEP OFF SKIN/AWAY FROM EYES. WASH OFF SPLASHES IMMEDIATELY. WASH HANDS AND EXPOSED SKIN AFTER USE. **Environmental protection:** To protect aquatic organisms and non-target plants do not apply on impermeable hard surfaces such as asphalt, concrete, cobblestones, tarmac, paving, patio and other situations with a high risk of run-off. Direct spray away from ponds and other surface water bodies. Risk to non-target insects and other arthropods. Avoid improper release into the environment. Do not contaminate water with the product and its container. Do not empty into drains. **Storage and disposal:** KEEP PRODUCT IN ORIGINAL CONTAINER, tightly closed in a safe place. Protect from frost. KEEP AWAY FROM FOOD, DRINK AND ANIMAL FEEDING STUFFS. KEEP PRODUCT AWAY FROM CHILDREN AND PETS. Do not re-use container for any other purpose.

ROUNDUP® Weedkiller Path Optima TO AVOID RISKS TO HUMAN HEALTH AND THE ENVIRONMENT, COMPLY WITH THE INSTRUCTIONS FOR USE.

- Read carefully and follow all instructions.
- Keep out of reach of children.
- If medical advice is needed, have product container or label at hand.
- Do not eat, drink or smoke when using this product.
- Contains reaction mass of 5-chloro-2-methyl-2H-isothiazol-3-one and 2-methyl-2H-isothiazol-3-one (3:1). May produce an allergic reaction.

Evergreen Garden Care UK Ltd, 1 Archipelago, Lyon Way, Frimley, Surrey, GU16 7ER, England, Telephone: +44 (0)1276 401 300.

For more information visit: www.roundup-garden.com

EU Importer: Evergreen Garden Care France SAS, 4 Allée des Séquoias, 69760 LIMONEST, FRANCE, Tel: +353 818 882 479.

MAPP No. 20722



BOTTLE

CAP

Recycle

Recycle

Contains 43.1 g/L Pelargonic acid as an Emulsion, oil in water (EW).

FIND OUT MORE ONLINE



PROTECT FROM FROST
ROUNDUP® is a registered trademark and used under licence.

†According to GFK Garden Care UK sales data 52 week (Sept 2022).



Keep children and pets
away from treated areas
until spray has dried

5 Litre e

